

Timelines



Volume 16, Issue 2

July 2019

www.coffeymuseum.org

Inside this Issue:

Kansas College	2-3
Pioneer Days	4
Grimm for Grownups	4
Church & School Restore	5
Lifetime Members	6
Membership & Brick Forms	7

We are looking for Weekend Volunteers. Contact the museum if you would like to become a Weekend Volunteer.



Board of Directors:

Jeri Page,
President, LeRoy

Ida Wilson,
Vice President, Lebo

Eileen Coker,
Secretary, At-Large Position

Kent Hoyt,
Treasurer, Burlington

Georgia Masten, Waverly

Dottie Stuart, Burlington

Johnnie Redding, Jr, Gridley

Museum Staff:

Museum Director:
Shirley Gorge

Administrative Assistant:
Erin Burdick

Presentation Explores Researching Your Home

Coffey County Museum in Burlington, KS will host “Researching Your Home and the People Who Lived There,” a presentation and discussion by Diana Staresinic-Deane on Saturday, August 24, 2019, at 1:00 p.m. at the Coffey County Museum, 1101 Neosho Street, Burlington, Kansas. Members of the community are invited to attend the free program. Contact the Coffey County Museum at 888-877-2653 for more information. The program is made possible by Humanities Kansas.

Researching a property—whether an old home, a new business, or a section of pastureland—can do more than tell us the history of a space; it can also help us build a human connection to the people who came before us and the history they experienced. This presentation helps participants consider creative ways to study documents and assemble a meaningful narrative with information found through research.

Diana Staresinic-Deane is the Executive Director of the Franklin County Historical Society and the Old Depot Museum in Ottawa.



Diana Staresinic-Deane

“New researchers will feel empowered to take their first researching steps,” said Staresinic-Deane. “Researchers who have been stymied by a dead end might just find the bread crumbs they need to progress.”

“Researching Your Home and the People Who Lived There” is part of Humanities Kansas's Movement of Ideas Speakers Bureau, featuring presentations and workshops designed to share stories that inspire, spark conversations that inform, and generate insights that

strengthen civic engagement.

For more information about “Researching Your Home and the People Who Lived There” in Burlington contact the Coffey County Museum at 888-877-2653.

About Humanities Kansas
Humanities Kansas is an independent nonprofit spearheading a movement of ideas to empower the people of Kansas to strengthen their communities and our democracy. Since 1972, our pioneering programming, grants, and partnerships have documented and shared stories to spark conversations and generate insights. Together with our partners and supporters, we inspire all Kansans to draw on history, literature, ethics, and culture to enrich their lives and serve the communities and state we all proudly call home. Visit humanitieskansas.org.



HUMANITIES KANSAS

A Movement of Ideas

James Vincent Coombs and the Kansas College

James Vincent Coombs was born in New Brunswick, Indiana, in 1849. He attended the Academy of Ladoga and the Philadelphia School of Oratory and Elocution. In 1877, he graduated from the Central Indiana Normal School and then graduated from the Chicago University in 1882. After graduation, Coombs became a teacher in the public schools. After a few years, he was elected president of Central Indiana Normal School and then East Illinois College for two years. In 1883, Coombs became the professor of history and literature in Eureka College (Illinois).

J. V. Coombs began seeking a town to start a new college in Kansas. He visited 35 different



Left: James Vincent Coombs was the president of Kansas College. He was a religious writer, minister, teacher and a college president.

towns on this quest. During April 1884, he visited Burlington and determined that Burlington was the best place in the state for a college.

The Kansas College and Normal School in Burlington, Kansas, was chartered by the state of Kansas in October 1884. The board of trustees of the new college were J. M. Lane, president; H. L. Jarboe, vice-president; A. C. Majors, secretary; Dr. W. Fosborn, treasurer; Warren Crandall, D. V. Mott, J. V. Coombs, Charles Puffer and Harrison Kelley. The board

positions would hold office for three years. Anyone subscribing and paying \$25 to the college fund were entitled to vote for the trustees.

There were six different location possibilities in Burlington for the school; (1) south of town, (2) two blocks west of Missouri Pacific depot, (3) west on Neosho Street, (4) on the King property northwest of town, (5) north on third street and (6) the park west of the courthouse. The final location for the college was decided on Reserve No. 2, the present site of the Coffey County Museum. The city deeded Reserve 2 to the college on December 4, 1884, with the stipulation that if the college failed, the land would revert back to the city.

On January 1, 1885, Professor J. V. Coombs was elected president of Kansas College for five years.

The first term of the Kansas College started on January 6, 1885, in the upstairs of the newly built Major's building in Burlington. The Major's building was owned by A. C. Majors and was located downtown on Neosho street where present day Veterans' Park is located.

The faculty consisted of J. V. Coombs, R. S. Gleason, P. F. Lent and W. E. Husselman. Several weeks after the start of classes, Gleason ran off with some money and left bills for the college. C. W.

Prettyman would then join the faculty.

The first courses taught at Kansas College were in all commercial and common branches, Latin algebra, rhetoric, and elocution.

The college offered night classes the following week of the start of the college. The night classes consisted of arithmetic, grammar, reading and penmanship.

The college building was to be 50' x 80' and 40' from the ground up. The first floor was to be 12 feet tall, the middle floor 13 feet and the top floor 17 feet. During March of 1885, the college building started to be built. By the end of April, a 50' x 80 stone foundation wall was finished above the middle of the first story window frames.

During the June 3, 1885 Burlington City Council meeting, a petition was presented for a \$10,000 bond to aid in the erection and completion of Kansas College



Above: 1885 map of Burlington showing where the college was located in Reserve No. 2, where the museum is located today.

Kansas College (continued)

building located on Reserve #2 in Burlington. The voting took place on June 16. A total of 411 voters turned out to cast their votes on the bond issue. The vote for the bonds failed 204-207.

At the July 1, 1885, Burlington City Council meeting, a petition for \$12,000 college bonds was presented for the purpose of constructing a public building for the use as a college building. The petition was signed by G. N. McConnell, W. J. Sanders, Jas. M. Baldwin and 140 voters. The bonds were voted on July 24 in what the *The Burlington Independent* called the “dirtiest election ever held in Burlington.” Floating votes were being bought from \$2 to \$8. In the end, the bonds lost by three votes.

A meeting was held on August 4 in the Majors’ building to decide what steps to take with the college.

Coombs was greatly disappointed in the lack of support from the Burlington community on the building of the Kansas College. He published an article in the *Kansas School Journal* and the *Burlington Independent* about his dissatisfaction in the matter. He stated “Burlington has decided that it did not want the college. This is three attempts within two years. Perhaps it is time to quit.” Arrangements were made with Professor Sanders, president of Kansas Normal College, Ft. Scott, Kansas, for the students from Kansas College to attend the school in Ft. Scott. Coombs then enters the lecture field and visited every state. He would die on December 20, 1920. It is unknown what happened to the foundation of the college and when it was torn down.

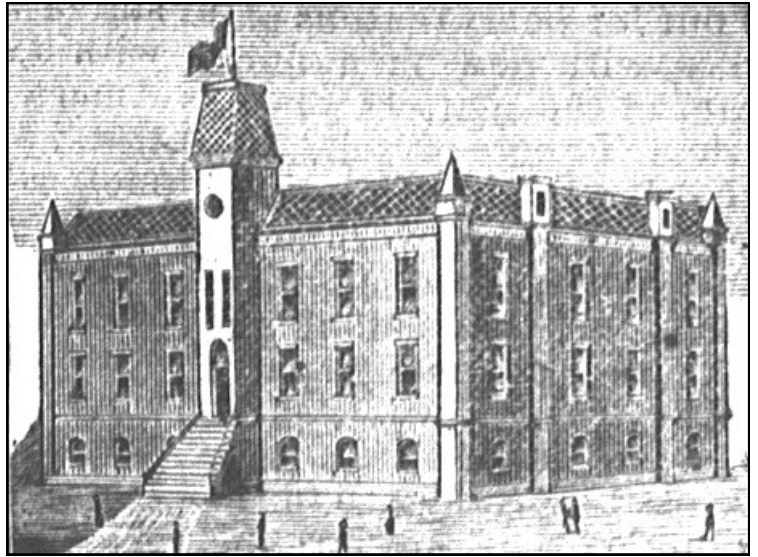

Above: Sketch of what Kansas College was going to look like but it was never completed. This sketch appeared in an ad for Kansas College in the Burlington Republican newspaper in 1885.

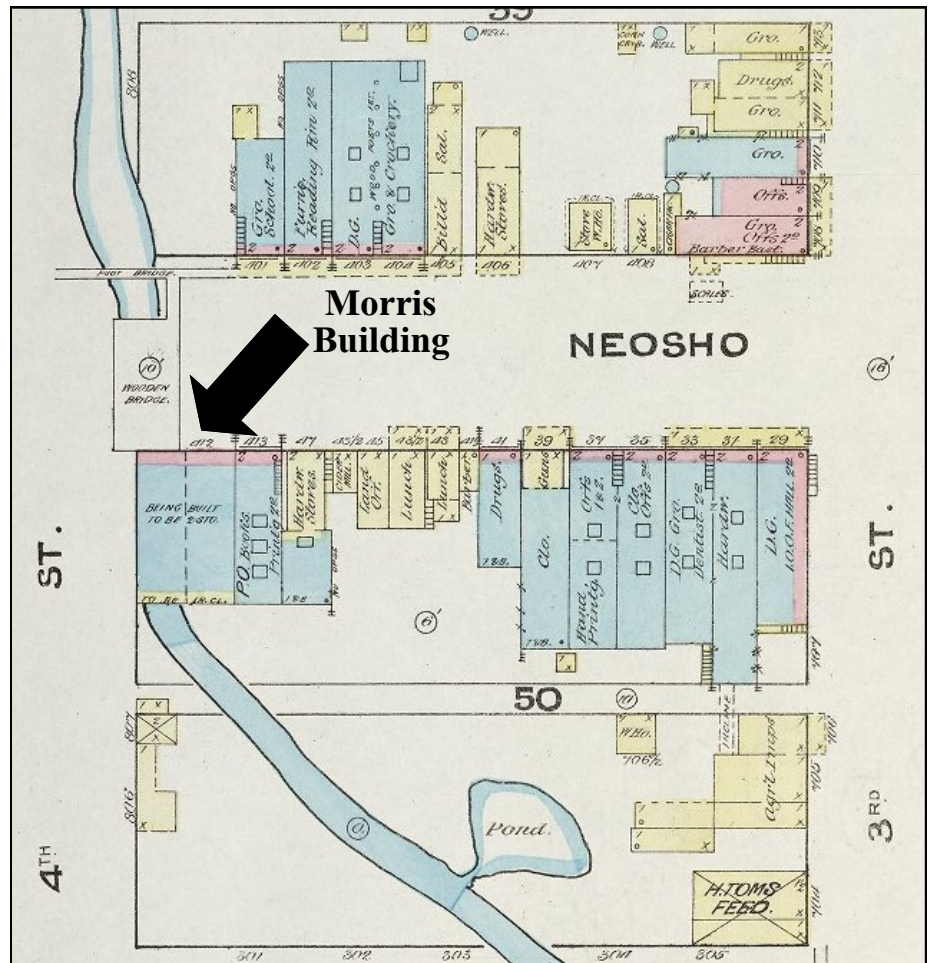

Above: 1884 Sanborn Fire Insurance Map of downtown Burlington showing where the Morris Building was located. The building was completed in 1885. Classes for the Kansas College were held in the building

Pioneer Days 2019

The Coffey County Museum's annual Pioneer Days will be held on Saturday, September 28, 2019, from 10:30 a.m. to 1:30 p.m. at the Coffey County Museum.

Attendees will have the opportunity to participate in pioneer activities throughout the museum. Some of the activities include rope making, candle dipping, butter churning, and yarn dolls. The train set in the Asbury Gallery will be running during this times.

All activities are free, but donations are greatly appreciated.

The pioneer activities were formally held in January during the Kansas Day Fundraiser. The fundraiser was renamed Museum Gala and moved to March and the activities were moved to September to month of September.

The museum is looking for volunteers to lead the different activities. If you are interested in volunteering, please contact the museum by email erin@coffeymuseum.org or by phone (888) 877-2653.



Yarn dolls is just one of the many activities that will be offered during Pioneer Days.

Presentation Explores the Brothers Grimm and their Folktales

Coffey County Museum in Burlington, Kansas, will host "Grimm for Grownups," a presentation and discussion by Priscilla Howe on Saturday, October 19, 2019, at 1:00 p.m. at Coffey County Museum, 1101 Neosho Street, Burlington, Kansas. Members of the community are invited to attend the free program. Contact the Coffey County Museum at 888-877-2653 for more information. The program is made possible by Humanities Kansas.

The Brothers Grimm traveled across Europe in the 1800s collecting folktales that eventually became the classic fairytales children read today. However, most were never intended for children. This talk explores the story of Jacob and Wilhelm Grimm and discusses why collecting folktales is important for understanding a community's values and fears.

Priscilla Howe is a freelance storyteller and a 2015 Fulbright Senior Scholar. A former children's librarian, Howe moved to Lawrence

in 1993 and became a global storyteller who has shared stories on 4 different continents.



Priscilla Howe

"Stories really aren't just for children. I love the Grimm tales even more as an adult than I did as a child, and I was a story-devouring kid," Howe said. "There's something in these stories that connects us on a deep level. It's like magic."

"Grimm for Grownups" is part of Humanities Kansas's Movement of

Ideas Speakers Bureau, featuring presentations and workshops designed to share stories that inspire, spark conversations that inform, and generate insights that strengthen civic engagement.

For more information about "Grimm for Grownups" in Burlington contact the Coffey County Museum at 888-877-2653.

About Humanities Kansas
Humanities Kansas is an independent nonprofit spearheading a movement of ideas to empower the people of Kansas to strengthen their communities and our democracy. Since 1972, our pioneering programming, grants, and partnerships have documented and shared stories to spark conversations and generate insights. Together with our partners and supporters, we inspire all Kansans to draw on history, literature, ethics, and culture to enrich their lives and serve the communities and state we all proudly call home. Visit humanitieskansas.org.

Church & School Restoration

Funds are still being raised to help restore the church and school. The buildings received a foundation lift in 2013. The splits in the siding on the buildings were filled to temporarily fix it until we have funds to replace the boards in poor condition with new boards.

The interior of the building still needs repaired. The last two fundraising events, Night at the Museum: Gatsby Edition and Kansas Day, were fundraisers for the restoration of the buildings. We are also collecting money for this cause. A donation form is located below if you are interested in donating to help restore the church and school buildings. A huge thank you to all of those who have already donated (see List of Donors) and to those

who have already attended our fundraisers.

If you have any questions regarding the restoration or how to donate, please contact the museum at (888) 877-2653.

List of Donors:

Foundation Lift:

- ★ Joyce Holderby
- ★ Kevin & Linda Graber
- ★ Cindy Eccles In Memory of E. Lucille Woods Atherly for Bethel Church
- ★ Anonymous

Restoration:

- ★ Anonymous
- ★ Margaret O'Leary



Above: Bethel Church
Below: Rural Dale Schoolhouse



Bethel Church & Rural Dale School House Donation Form

The Coffey County Museum is a non-profit 501(c)(3) organization. Most donations can be tax deductible. Please see your accountant for more information on tax deductions.

Name: _____

Address: _____

City: _____ State: _____ Zip: _____

Phone Number: (____) _____ Alt. Number: (____) _____

Would you like your name listed as a donor? _____

If yes, how would you like your name listed? _____

Amount of Donation: \$ _____

Type of Donation (circle one): Cash Check Money Order

A letter will be sent out as a receipt of the donation within a week of receiving the donation. If you have any questions, please call Erin at (620) 364-2653 or toll free at (888) 877-2653 or email erin@coffeymuseum.org.

Lifetime Members

Ackerman, Gayla Lonene	Evans, Sue	Kniss, Clarence	Reeves, Karen K.
Adkins, Joan	Evans, Terry L.	Kniss, Donna	Reimer, Paul
Allegre, Peter	Ferrara, Melchoir A.	Krebs, Tammy Hoover	Reisbig, Clara L.
Allen, Dan	Finkbiner, Patricia	Krigbaum, Marilyn	Robbins, Carol A.
Allen, Linda K.	Finkbiner, Terry	Kunkel, Connie	Roth, V. Cameron
Anliker, Tyler	First National Bank of Kansas	Kunkel, David	Salava, Dan
Atherly, Mary Lou DeLong	Fitch, Duane	Kunkel, Opal I.	Salava, Linda J.
Atkin, John D. M.D.	Freeman, Bill	Lifecare Center of Burlington	Salisbury, Florence Conrad
Atkin, Patricia	Freeman, Calvin Dean	Little, Charles F.	Sanborn, Patty A
Bailey, Jerry	Freeman, Diane	Lowman, Nadine	Sauder, Ray
Banks, Peggy	Freeman, Elva	Luke, Linda Sue	Schick, Donald L.
Beaty, W. Jean	Freeman, Jeff	Luke, Lola Mae	Schick, Ruth
Bedwell, L.F.	Freeman, Joan	Luke, Robert Standley, Jr	Schultz, Achsah Carter
Birk, Julia Mae	Fulk, Doris L.	Martindale, Paul	Sleezer, Johnnie R.
Bohrer, Paul	Garrett, Emily	Matney, Linda J.	Sleezer, Retha I.
Born, Linda	Garrett, Lisa I.	Mattox, Martha	Smith, Darlene
Brecheisen, Betty	Garrett, Millie	McAlister, M.A.	Smith, Ivan
Bruce, Nellie	Geery, Barbara	McAlister, V.S.	Smith, Marjorie J.
Bruce, Robert Lyle	George, Dennis	McConnell, John	Smith, V LaVerne
Central National Bank	Graber, Kevin	McReynolds, Richard L.	Spade, Sharon
Citizens State Bank	Graber, Linda	Meadar, Craig	Spatz, Caroline B.
City of Burlington	Griffin, Lena	Meadar, Peggy	Spatz, Robert J.
City of Lebo	Hatch, Bonnie	Merry, Barbara	Spriggs, Judy
Clapp, Grace (Sauder)	Hatch, Homer	Merry, Gene	Stine, Phyllis A.
Clark, Joanna	Hayes, Edris Irwin	Montgomery, Dean R	Stukey, Arthur
Clark, Larry	Herr, Bob	Morey, George	Stukey, Kent
Cochran, Dorothy	Hess, Wayne	Muench, Cheryl	Sunseri, Carol
Cockrell, Gilan	Holderman, Jenifer	Muench, Rick	Trimble, Chuck
Coffey County Chamber of	Holderman, Rich	Neil, Eunice Johnson	Trimble, Joyce
Commerce & Visitors Center	Hood, Betty Jo	Norris, David	Trimble, Randy
Coffey County Commissioners	Hood, Herbert	Norris, Kasu Stinson	Trostle, Jerilee
Coffey County Council for the	Hoover, Carlita	O'Leary, Dennis	Trostle, Kerry
Arts	Hoover, Lisa	O'Leary, Margaret R.	TrustPoint Services
Coffey County Honda	Hoover, Ned	Oliver, Connie	Ubert, Ann
Coffey County Hospital	Hoover, Ron	Oliver, Kenneth	Ubert, Gary
Coffey County Land Title Co.	Hoover's Thriftway	Park, William H.	Vannocker, Rebecca Louise
Inc	Hoyt, Kent	Parnay, Arlene Carpenter	Veteto, Mona
Coffey County Library	Hoyt, Lori	Payne, Janet	Watson, Irene
Coldsmith, Don	Hull, Kelly J.	Ponder, Mary Lou	Wildman, Kay
Coldsmith, Edna	Hull, Sheldon L.	Ponder, Randy	Wilkinson, Al
Combes, Irene E.	Irey, Diana L.	Purvis, Lois Jean	Wilkinson, Opal
Combes, Kenneth L.	Irey, Ronald W.	Raaf, Clarence	Williams, James E., Jr.
Conrad, Mary E.	Johnson, Cloyce E.	Raaf, Esther	Williams, Kathleen (Asper)
Cordell, Larry	Johnson, Diane S.	Raaf, Fred A.	Williamson, Arthur W.
Cox, Juanita	Johnson, Jerry D.	Raaf, Gary	Williamson, Bernice
Croll, Susan	Johnson, John E.	Raaf, Harvey G.	Williamson, Mitch
Curtiss, Jerilyn	Johnson, Loren E.	Raaf, James L.	Wilson, Ida M.
Curtiss, Larry M.	Jones, Carol	Raaf, JoAnn	Wilson, Warren D.
Danford, Charlene	Jones, Don	Raaf, Mark	Wolf Creek Nuclear Operating
DeLong, Roy G.	Jones, Fred S.	Raaf, Ralph	Corporation
Dunlap, Dr. James	Jones, Glenda	Raaf, Richard	Wolken, Deanna
Dunlap, Judith	Jones, Paul	Raynesford, Carolyn C.	Woods, Chloe
Edelman, Albert L.	Kaufman, Helen Garn	RC Trucking, Inc	Woods, Frank
Edelman, Victor	Keas, Sandy K.	Redding, Bud	Worrell, Dallas G.
Epting, Gary	Kennamore, Deborah	Redding, Carol	Zscheile, Lila L.
Epting, Polly	Kennamore, William "Pete"	Redding, Johnnie Jr	
Evans, Dean	Klubek, Brenda Grace	Redding, Patricia	
Evans, George	Knapp, Bill	Reeves, Glen W.	

*new members are bolded

225 Total Lifetime Members

Membership Form

Name: _____

Address: _____

City: _____ State: _____ Zip: _____

Phone Number: (____) _____ Alt. Number: (____) _____

Email address: _____

Would you like your newsletter emailed to you? _____ Would you like to be a volunteer? _____

Name as you would like it to appear on membership: _____

Type of membership (please circle one):

- Individual (\$5.00 annual per person)
- Business (\$15.00 annual per business)
- Lifetime (\$100.00 one time fee per person)

*Please mail completed form and check or money order to:

Coffey County Museum
 1101 Neosho Street
 Burlington, KS 66839

If you have any questions or would like to know the status of your current membership, please call Erin at (620) 364-2653 or toll free at (888) 877-2653 or email erin@coffeymuseum.org.

Coffey County Historical Museum

Gazebo Bricks

Purchase a personalized brick that surrounds the Gazebo for \$40 each.

Please Note: Bricks will only be engraved once there are ten bricks that need to be engraved. This may take weeks or years.

Name: _____

Address: _____

City: _____ State: _____ Zip Code: _____

Phone: _____ Email: _____

***Please make checks or money orders payable to: **Coffey County Historical Museum**

Each brick may have 2 lines of print with 13 spaces each.

Coffey County Historical

Society & Museum

1101 Neosho Street
 Burlington, KS 66839
 620-364-2653
 1-888-877-2653
www.coffeymuseum.org
 email:
visit.us@coffeymuseum.org

Calendar of Events

July

4- Independence Day- Museum Closed
11- Board Meeting @ Noon
24-27- Coffey County Fair

August

8- Board Meeting @ Noon
24- Researching Your Home @ 1 p.m.

**bold items are important dates at the museum.*

September

2- Labor Day- Museum CLOSED
11- Patriot Day
12- Board Meeting @ Noon
23- Autumn begins
28- Pioneer Days

October

5- Taste of Fall @ Kelley Park
6- Wedding @ Museum
10- Board Meeting @ Noon
14- Columbus Day
31- Halloween

Coffey County Historical
Society & Museum
1101 Neosho St.
Burlington, KS 66839

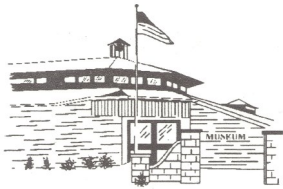

Take a walk through history!

We're on the web!
coffeymuseum.org



Visit us on Facebook!
www.facebook.com/coffeymuseum

VIEWING HOURS:

Summer Hours: (March to October)
Monday- Friday 10:00 a.m. to 4:00 p.m.
Saturday 1:00 p.m. to 4:00 p.m.*
Sunday 1:30 p.m. to 3:30 p.m.*

**Open as volunteers are available*

Winter Hours: (November to March)
Monday- Friday 10:00 a.m. to 4:00 p.m.
CLOSED on Weekends and Federal Holidays